

WELCOME TO HYVINKÄÄ STATION

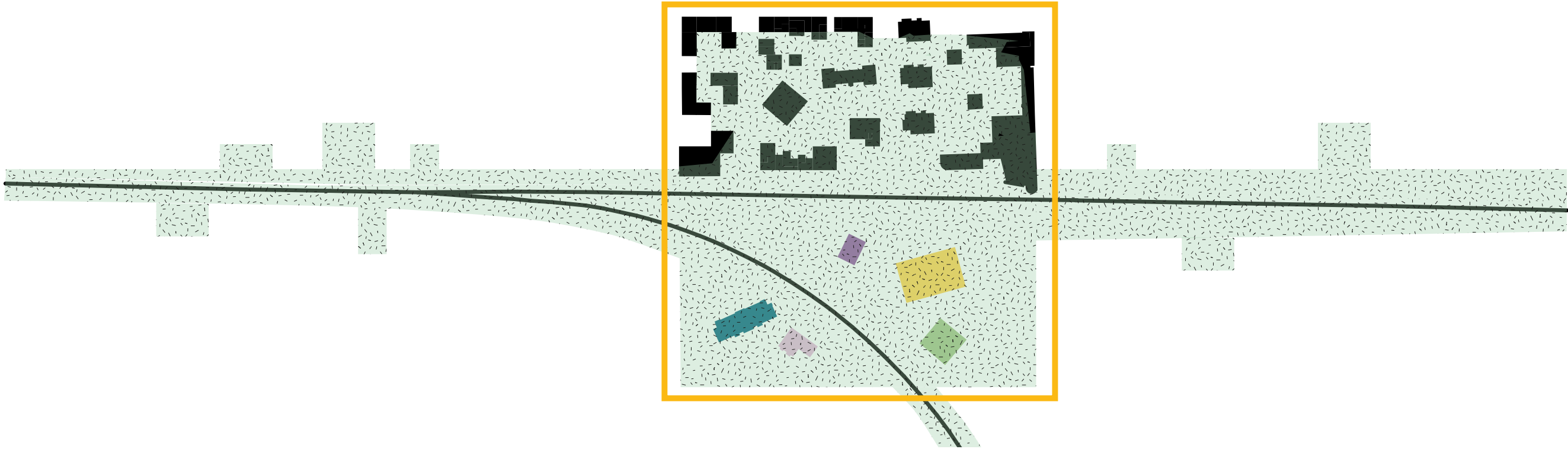

PRODUCTIVE POCKET

Hyvinkää, a connected city through the train and along the landscape. The arrival of Hyvinkää is represented by the station which defines its identity. A symbiotic pocket provides a welcome area, which defines both worlds of the city, the green and urban. So, now Hyvinkää is strategically located within the territorial framework of Finland.

FROM OWNERSHIP TO SHARING MOBILITY

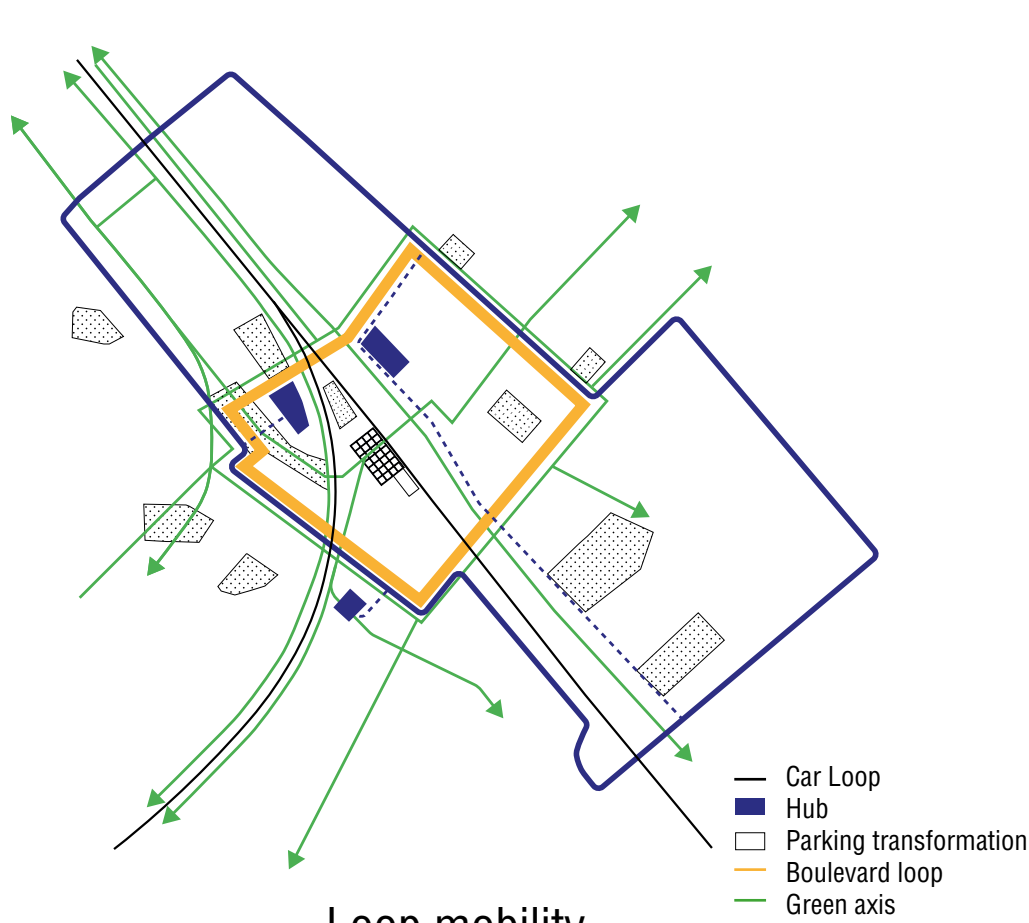

Loop mobility

A concept of outer traffic and inner boulevard loop allows a fluent and not crossing flows between them. Green axis supply a transversal network into the city.

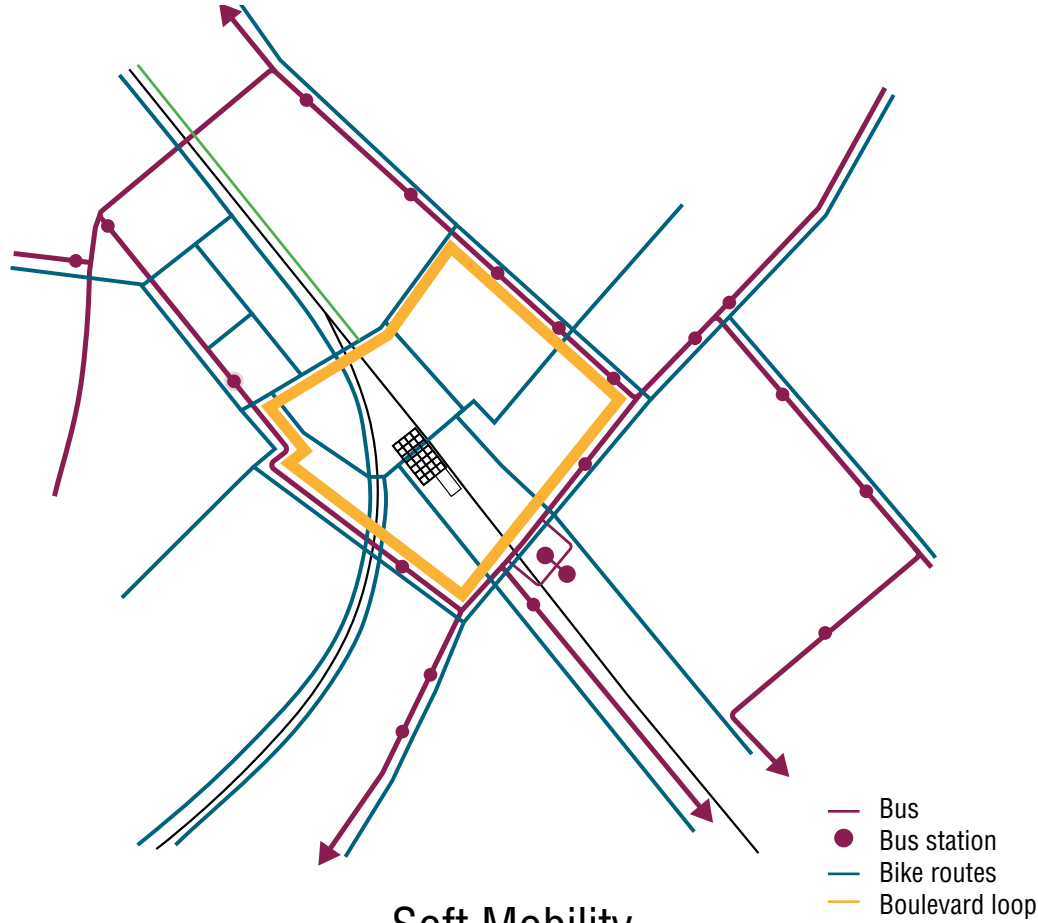

Soft Mobility

Upgrading the infrastructure to support soft mobility, as a sharing system allows a productive way of transportation, clean and effective.

REVEAL THE GREEN

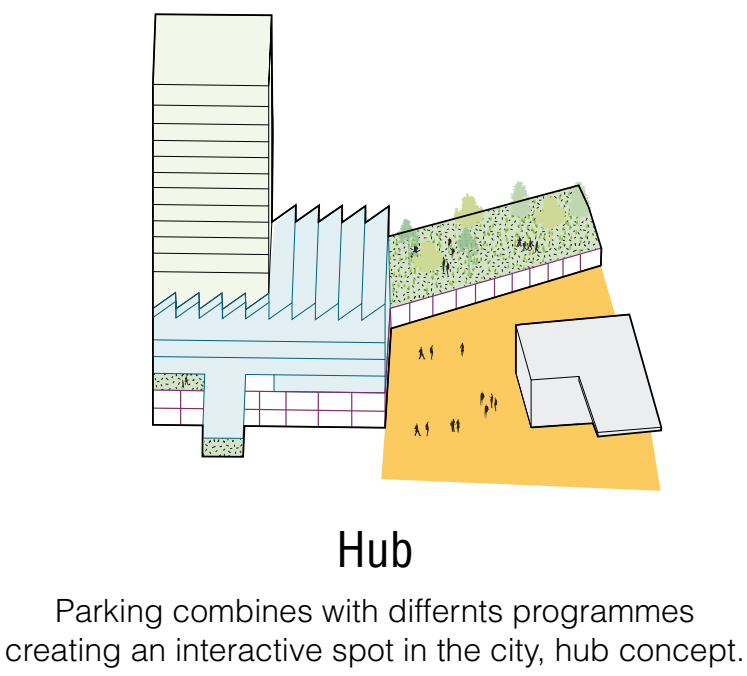

Hub

Parking combines with differnts programmes creating an interactive spot in the city, hub concept.

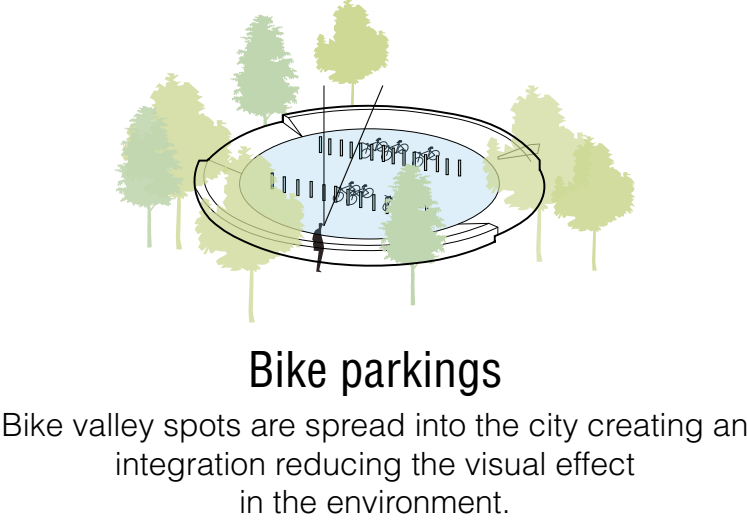

Bike parkings

Bike valley spots are spread into the city creating an integration reducing the visual effect in the environment.

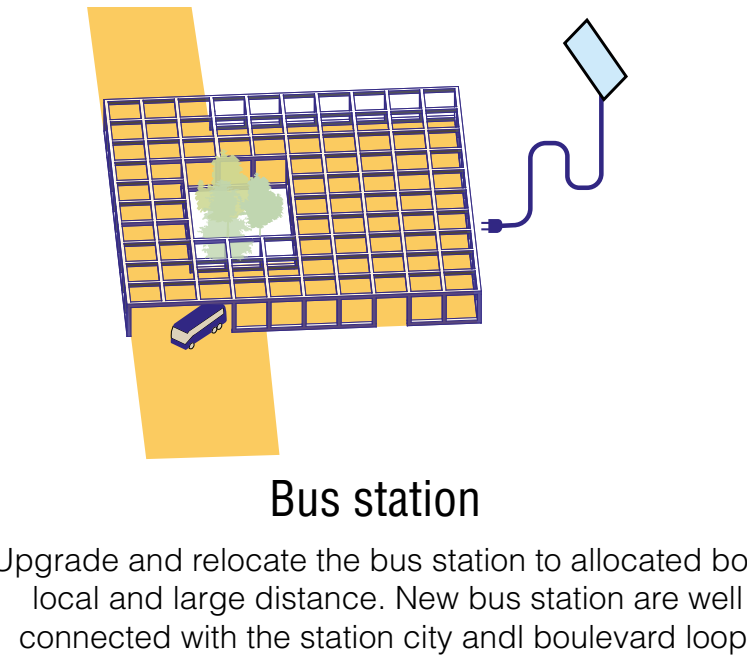

Bus station

Upgrade and relocate the bus station to allocated both, local and large distance. New bus station are well connected with the station city andl boulevard loop.

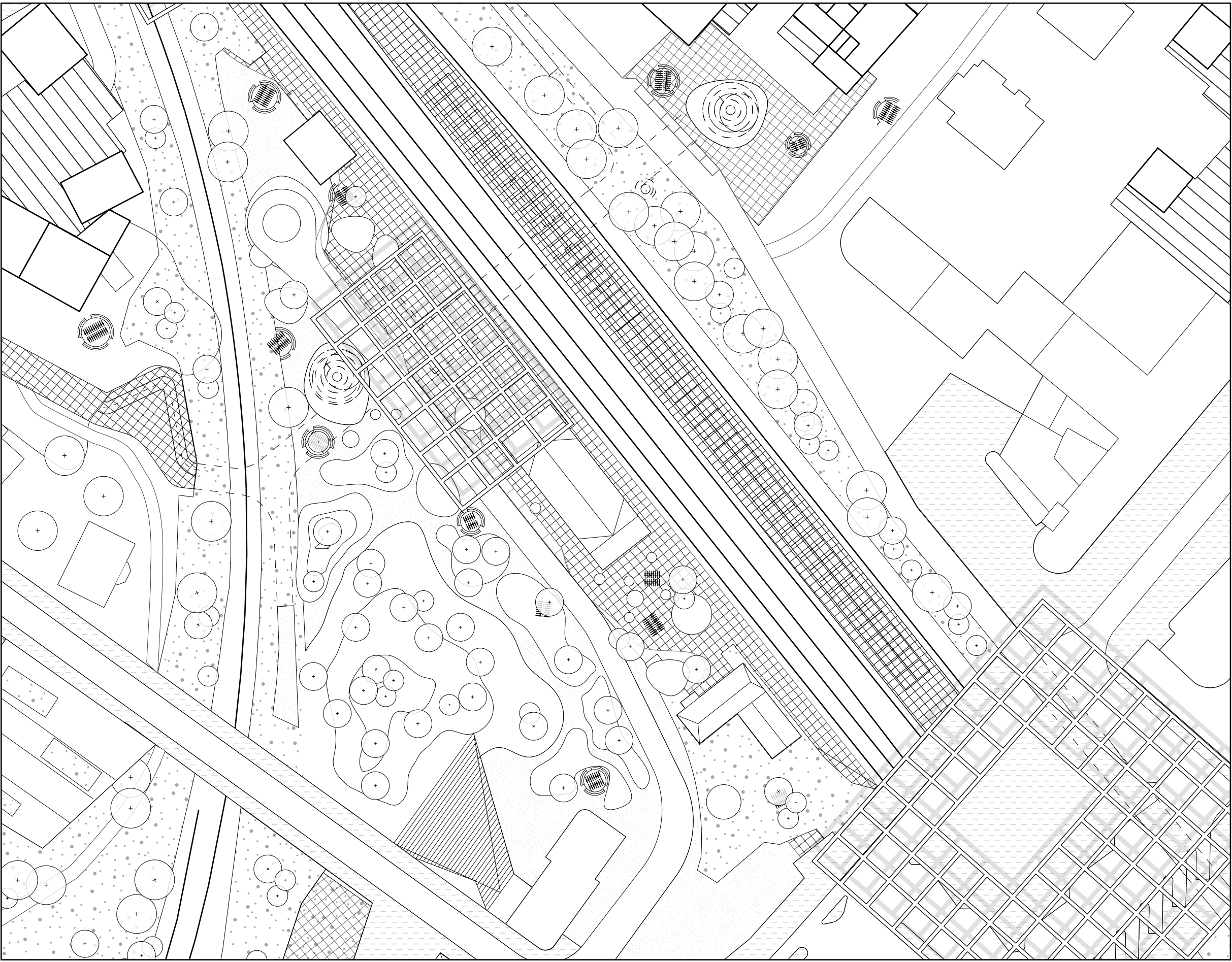

SURROUNDINGS HYVINKÄÄ STATION 1:1000

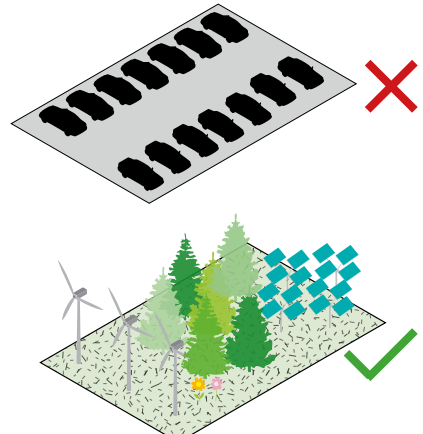

Reduce free parking

Sharing mobility allows reducing the free parking space in order to transform into productive areas for the city.

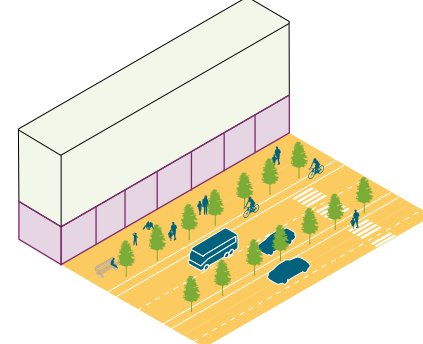

Urban boulevard

New urban loop boulevard transform the city into a connected area between the areas. Interactions and activities pop up in the city.

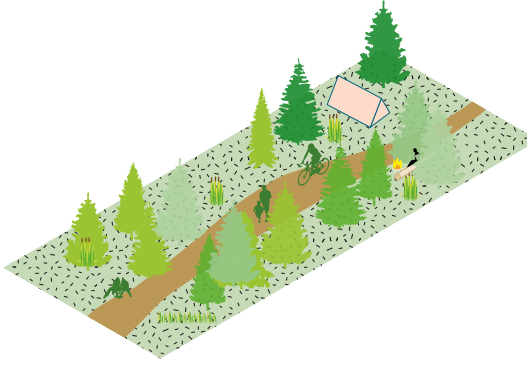

Healthy routes

Reveal the landscape within the city as a strategy to implement activities related to the nature closed to the city.

